

S. MIDWEST BLVD & E. RENO AVE MIDWEST CITY, OK 73110

FOR LEASE—BUILD TO SUIT



Property Information:

- Use: Build to Suit
- Terms: Lease
- Total Land size: 35,000 sf
- Potential Bldg. size: 4,000—5,000 sf
- Price per SF: Negotiable
- Commercially Zoned

Property Highlights:

- Visibility: High
- Adjacent to Security Self Storage
- Great location for restaurant, retail, or professional office
- Near I-40, MWC Regional Hospital, MWC city offices and restaurants
- Close to Tinker & retail shops

Contact:

ROD BAKER, CCIM

Email: bakerr@bakerfirst.com

Phone: 405-947-7200

Cell: 405-818-2800

Fax: 405-947-7270



Responsive • Reliable • Results

Brokerage • Development
Construction • Investments
Property Management

www.bakerfirst.com

2800 NW 36th Street • Oklahoma City, OK • 73112

S. MIDWEST BLVD & E. RENO AVE MIDWEST CITY, OK 73110

FOR LEASE—BUILD TO SUIT

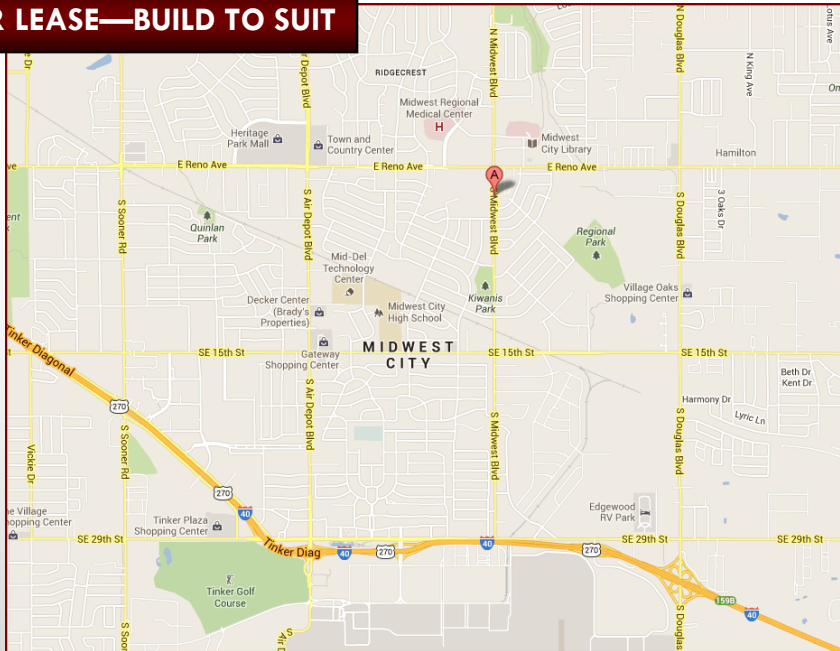

Contact:

ROD BAKER, CCIM

Email: bakerr@bakerfirst.com

Phone: 405-947-7200

Cell: 405-818-2800

Fax: 405-947-7270



Responsive • Reliable • Results

Brokerage • Development

Construction • Investments

Property Management

*All offerings subject to change, sale, lease or withdrawal without prior notice.
Details believed to be accurate at time of print.*